

USING PRESSURE SYSTEM

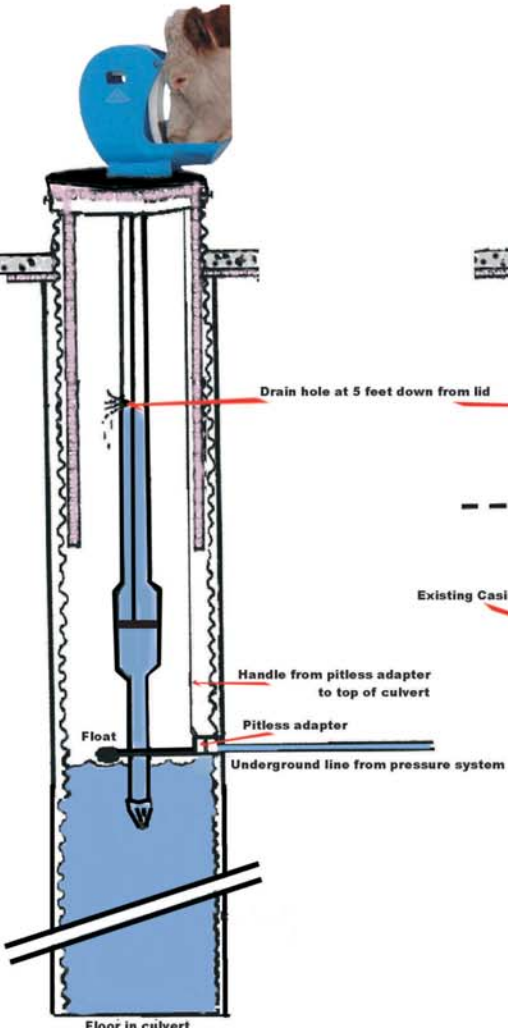

OVER EXISTING CASIED WELL

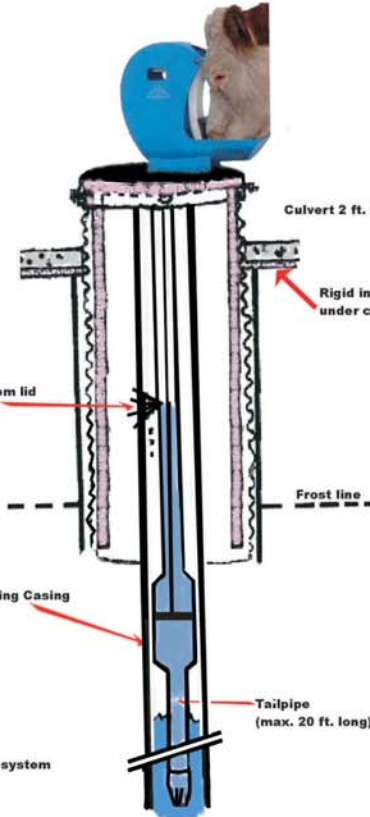

OVER BORED WELL

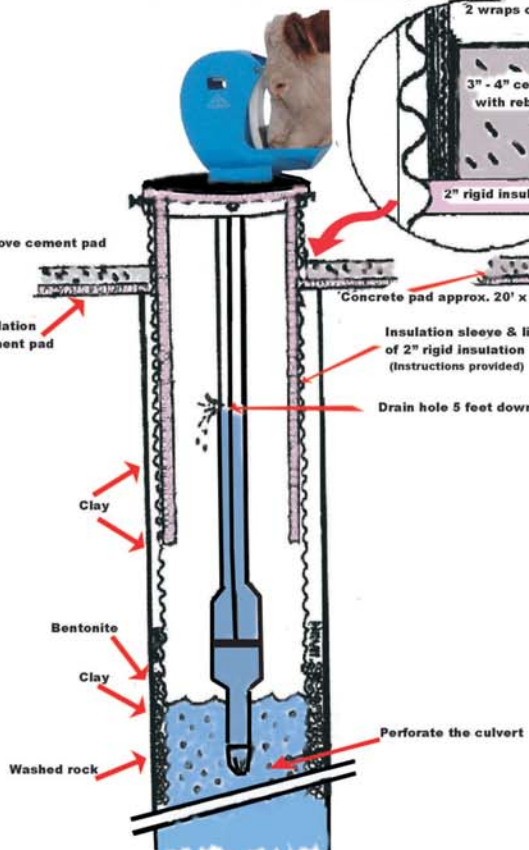

BESIDE DUGOUT (POND) OR SPRING DEVELOPMENT

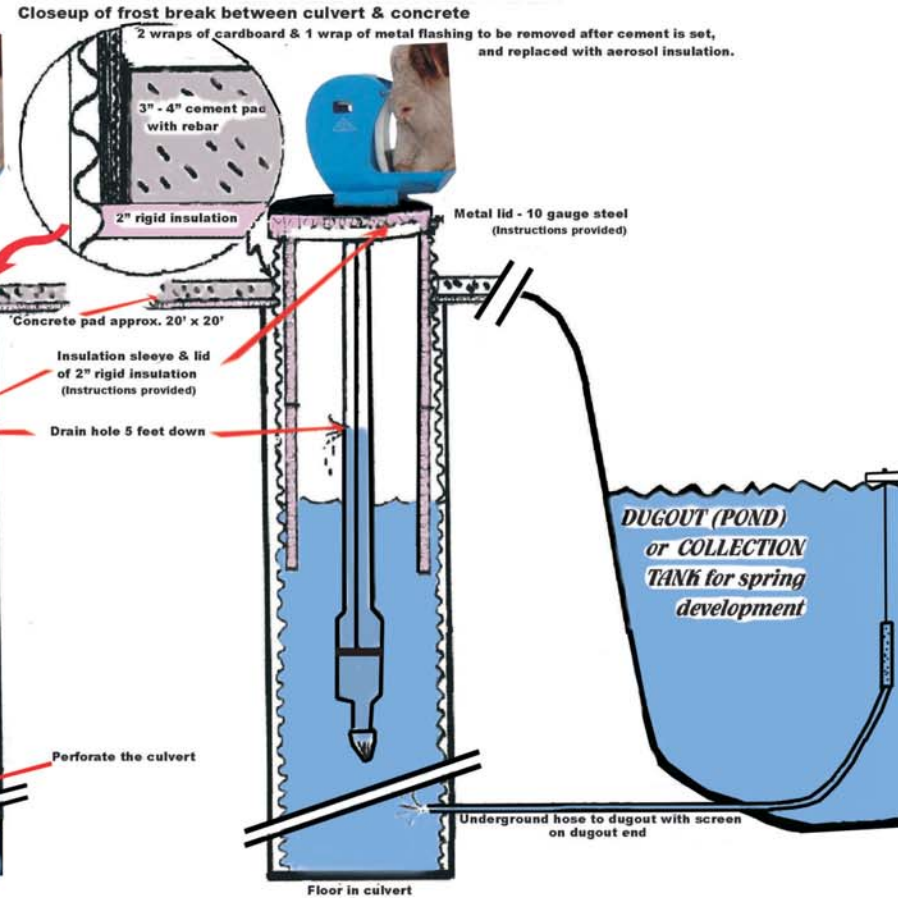

Recommended minimum length for culvert is **23 feet** except for existing cased well which can then be **12 feet**

Recommended minimum culvert diameter is **24 inches**.

Frostfree Nosepumps Ltd. — 1-866-843-6744